

## 270.7250 | Two Output Shower W/ Rain Head & Hand Held

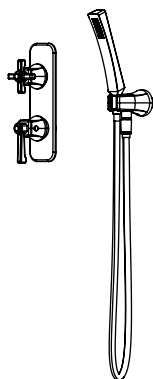
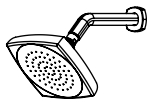

### COMPONENTS

- RHW.7C - 7" Head w/8" Arm
- 270.4000VT - Shower Trim
- TVH.2717F - Shower Valve
- HS1026H - Hand Held
- 270.8006 - Wall Elbow w/ Holder
- SP.150EM - 1.5m Hose

### SHOWER VALVE:

- Thermostatic shower valve
- Valve includes service stops
- Turn bottom handle to set temp.
- Top handle controls water diversion
- Includes 15109 non-shared cartridge

### SHOWER HEAD:

- Solid brass construction
- 1.8 GPM flow rate

### STANDARDS:

- ASME A112.18.1 / CSA B125.1

See individual component specification sheets on following pages for further details.

## RHW.7C | 7" Brass Shower Head With 8" Wall Mount Shower Arm

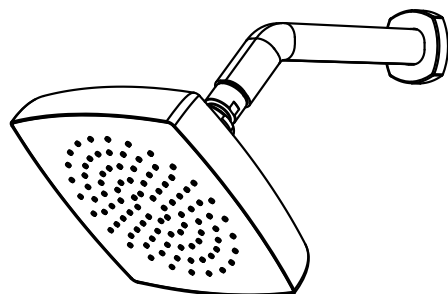

### SPECIFICATIONS:

- Solid Brass construction
- With Swivel action
- Shower arm has sliding flange

### STANDARDS:

- ASME A112.18.1 / CSA B125.1

### Technical Diagram

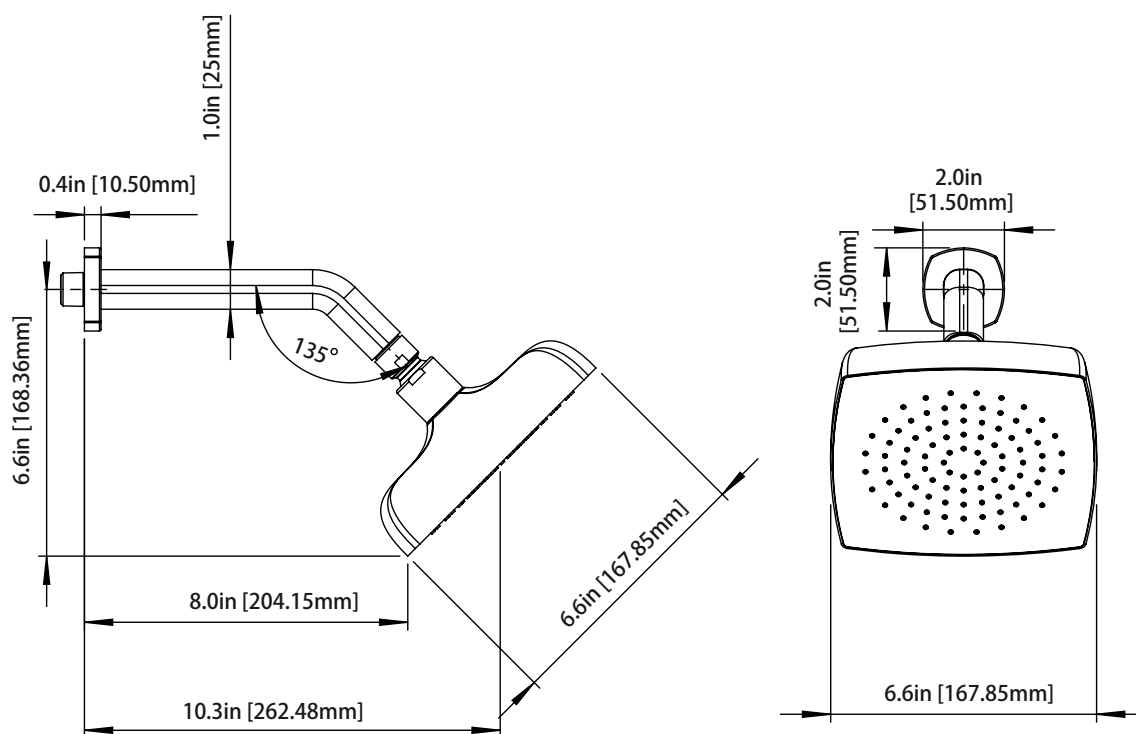

## 270.4000VT | Thermostatic Shower Trim

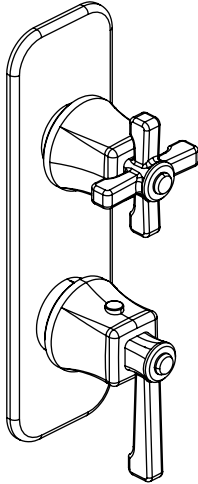

### SPECIFICATIONS:

- Solid Brass construction
- Valve not included - Trim only
- Bottom knob controls temperature
- Top knob controls volume
- Use in tub filler or shower applications

### Technical Diagram

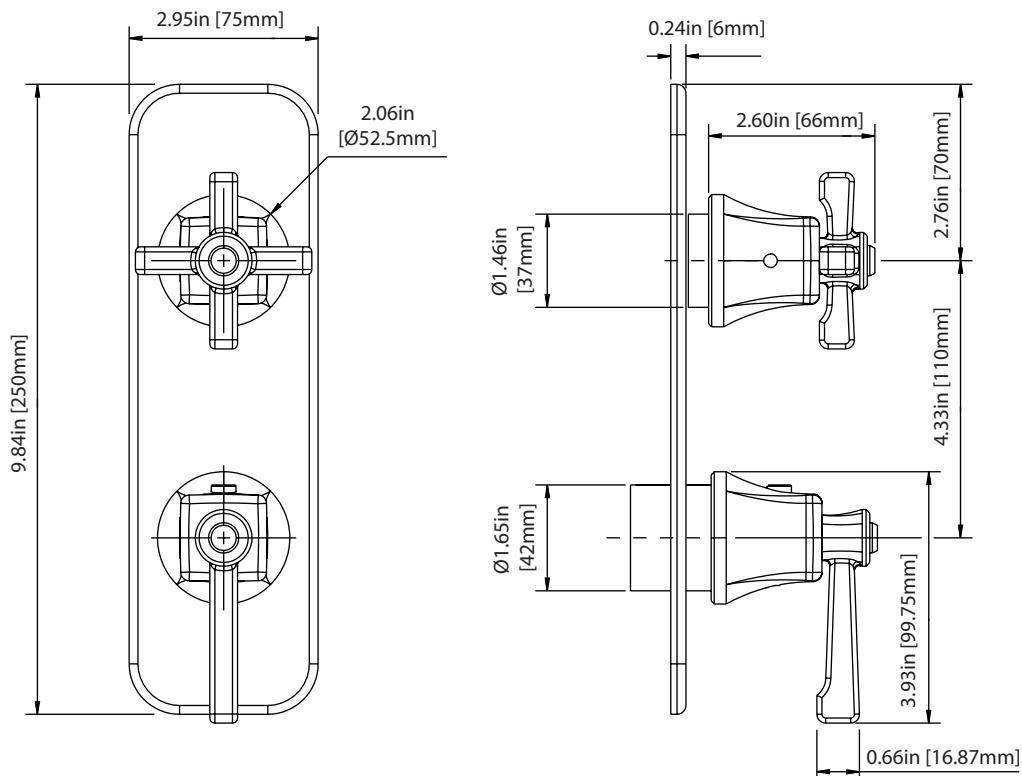

# TVH.2717F | 3/4" Thermostatic Valve With 2-Way Diverter & Integrated Volume Control

Page 1 of 2

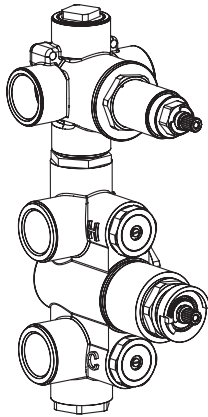

## SPECIFICATIONS:

- Turn bottom knob to control temperature.
- Turn top knob to control water flow.
- Thermostatic Valve Flow Rate - 8.0 GPM @ 60 PSI
- Extension Available - TVH.4101E\*\*

## STANDARDS:

- ASME A112.18.1 / CSA B125.1

**!** A separate volume control is **not** needed to turn water supply off. Volume control functionality is integrated within this valve.

## Technical Diagram

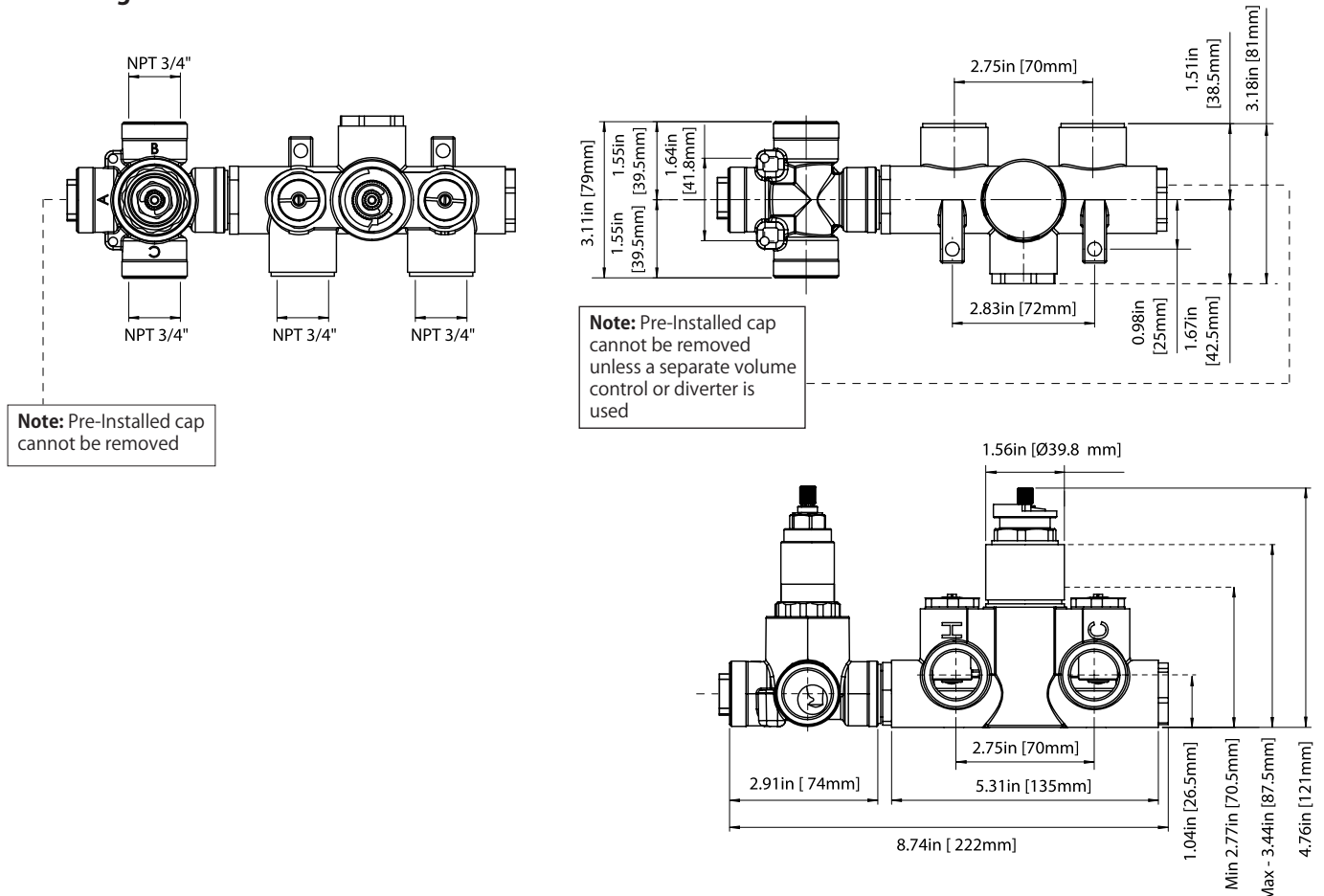

**TVH.2717F | 3/4" Thermostatic Valve With 2-Way Diverter & Integrated Volume Control**

Page 2 of 2



**TWO OUPUT - CAL-GREEN - NO SHARED PORT OPERATION**

Diverter Cartridge # - **15109** (Included)

Total 3 Positions as defined below, with **only** 1 port active at one time.

- Position 0 - Off - No Water Flow
- Position 1 - Output B Activated
- Position 2 - Output C Activated

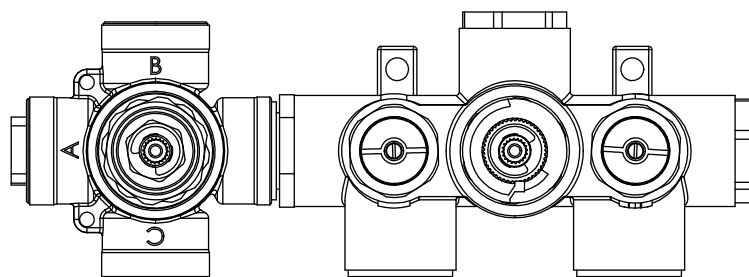

**TWO OUPUT - SHARED PORT OPERATION**

Diverter Cartridge # - **15103** (Not Included)

Total 4 Positions as defined below, with 2 ports active at one time.

- Position 0 - Off - No Water Flow
- Position 1 - Output B Activated
- Position 2 - Output B+C Activated
- Position 3 - Output C Activated

## HS1026H | Solid Brass Hand Shower

### SPECIFICATIONS:

- Solid Brass Construction
- 1.8 GPM Flow Rate
- With back flow prevention check valve

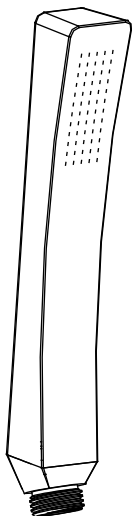

### Technical Diagram

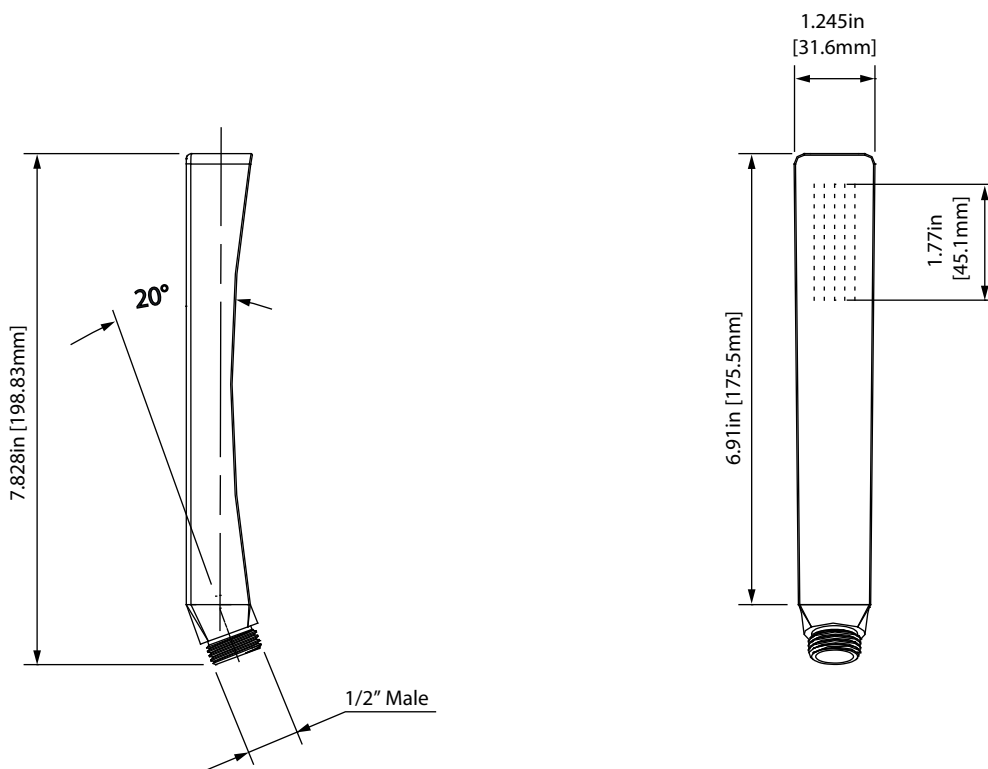

## 270.8006 | Wall Elbow With Holder Combo

### SPECIFICATIONS:

- Solid Brass Construction
- Includes Check Valve with back flow prevention.

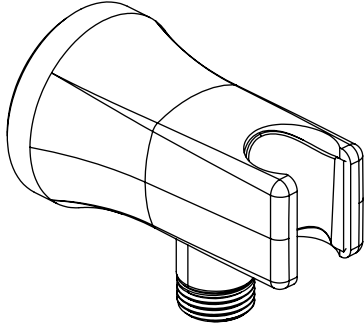

### Technical Diagram

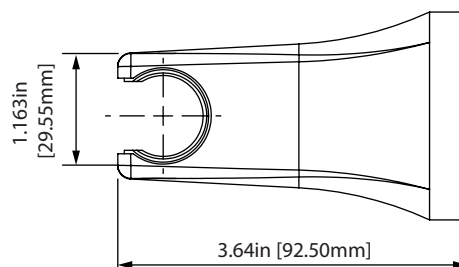
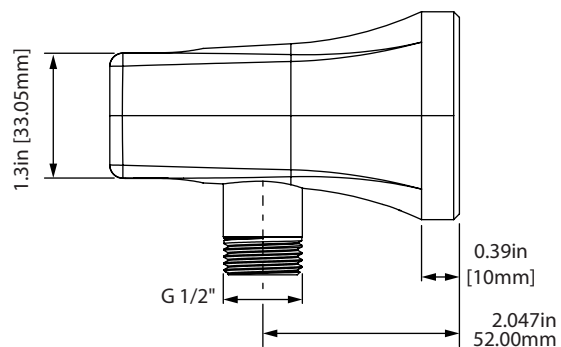
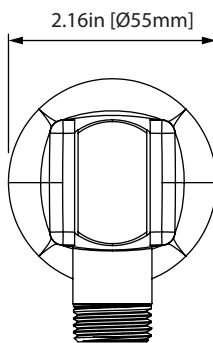

SP.150EM | Easy Maneuver Hose

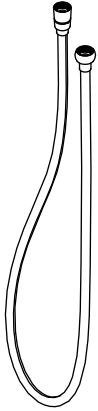

SPECIFICATIONS:

- Stainless steel construction
- G-1/2" connection
- 1.5m length

Technical Diagram

